



CAR689

Quick Start Guide Multimedia Receiver with 6.8" capacitive touch screen

JENSEN

This Quick Start Guide
gives you the basics to start using
your CAR689

Please visit <https://www.jensenmobile.com/user-manuals.html> to download a complete owner's manual,
or call our friendly customer service at

1-888-921-4088
(Monday-Friday, 9AM-5PM EST)



Installation

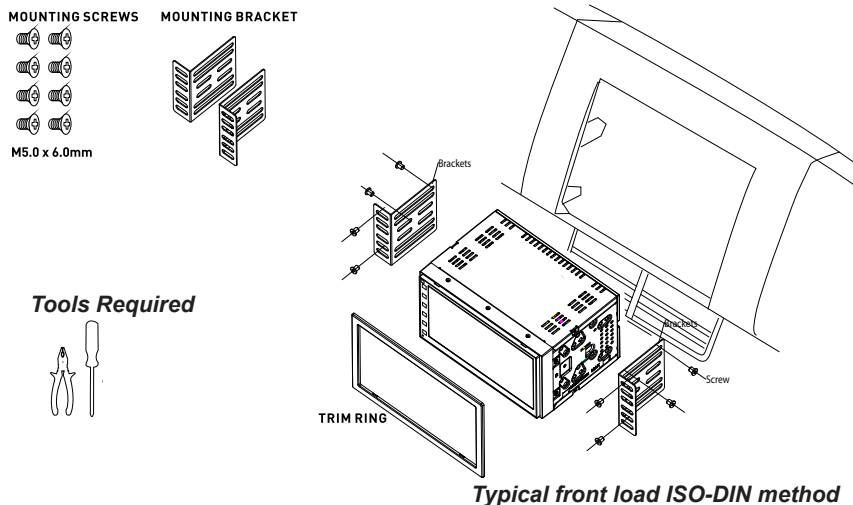

Wiring Diagram - Input / Outputs

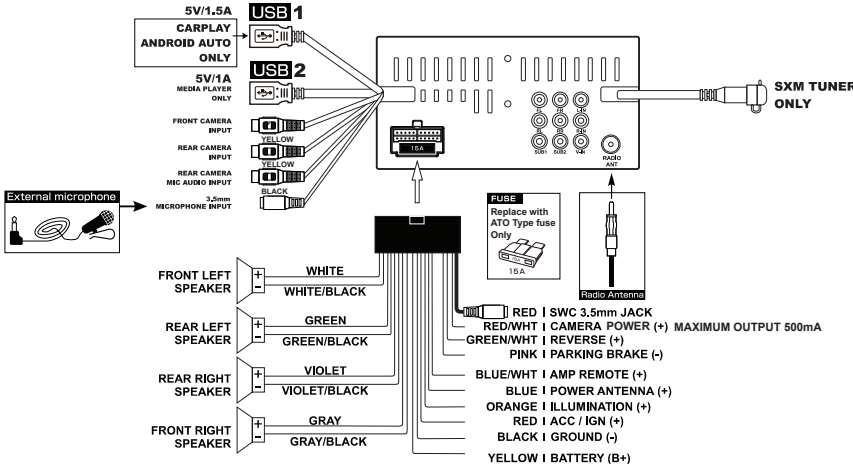

Copyright and Trademark Notes

Apple CarPlay is a trademark of Apple Inc. / Use of the Apple CarPlay logo means that a vehicle user interface meets Apple performance standards. Apple is not responsible for the operation of this vehicle or its compliance with safety and regulatory standards.

Please note that the use of this product with iPhone, iPod, or iPad may affect wireless performance. iPhone, and Apple are trademarks of Apple Inc., registered in the U.S. and other countries. Availability of Android Auto™ may vary depending upon your country and phone model. Please visit android.com/auto for more information.

Android, Android Auto, Google and other marks are trademarks of Google Inc.

The Bluetooth® word mark and logos are registered trademarks owned by Bluetooth SIG Inc. SiriusXM and all related marks and logos are trademarks of Sirius XM Radio Inc. All rights reserved. All trademarks and trade names are property of their respective owners.

All rights reserved. No part of this publication may be reproduced, distributed, or transmitted in any form or by any means, including photocopying, recording, or other electronic or mechanical methods, without the prior written permission of Namsung America Inc.

Control Panel



1. Power On/Off
2. Volume Up
3. Mute
4. Volume Down
5. PTT Voice Assistant
6. Source Menu
7. System RESET

Safety Notice



Video / movie playback will not operate while the vehicle is moving. This is a safety feature to prevent driver distraction. In-dash video / movie functions will only operate when vehicle is in Park and the parking brake is engaged. It is illegal in most jurisdictions for the driver to view video while the vehicle is in motion.



First Time Setup Wizard

The SETUP WIZARD can be skipped at any time.

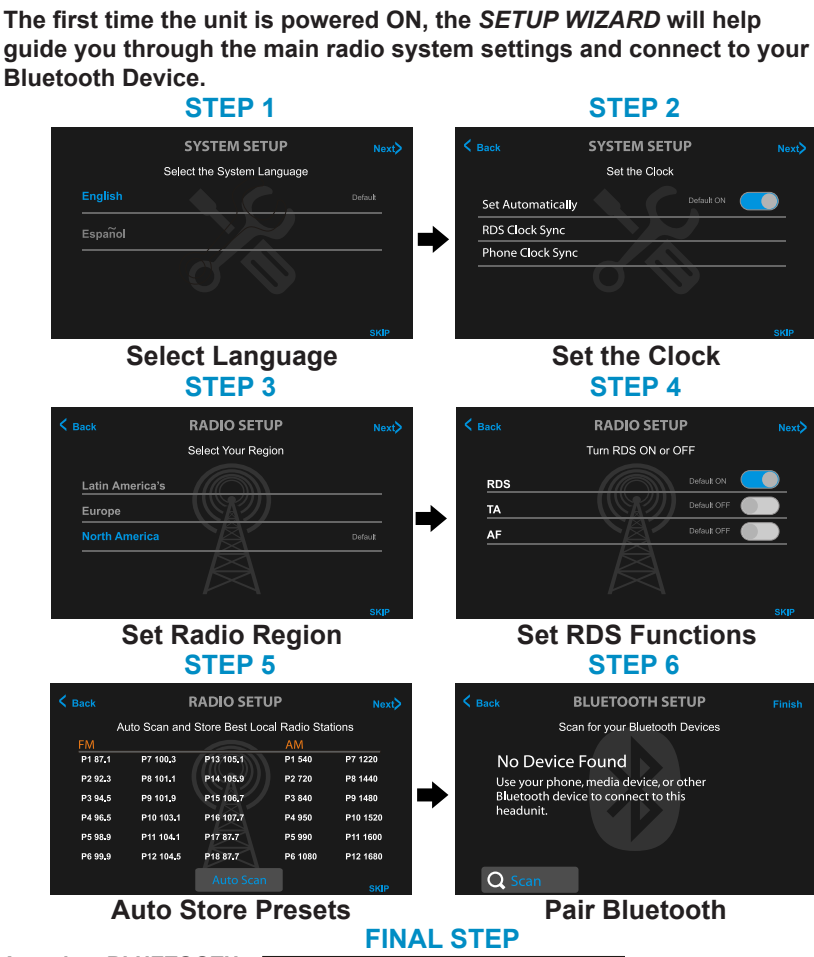

A random BLUETOOTH PASSCODE will be generated, follow the on-screen instructions, press Ok on your Device

Tips

To rerun the WIZARD again, press RESET button with a paperclip for 3 seconds.

Main Menu

Press the Top Left Source icon to enter Main Source Menu
In the Menu mode, press the desired icon to enter the desired mode:

1. Quick Select Sources
2. Radio
3. Media Player
4. CarPlay | Android Auto
5. Full Screen Clock
6. EQ
7. Rear Camera
8. Front Camera
9. Auxiliary AV Input
10. BT Music
11. SXM Direct Selection
12. USB Media Port
13. BT Handfree Calling
14. Settings Menu



CarPlay or Android Auto Operation

Connect your Device to REAR USB CarPlay/Android Port

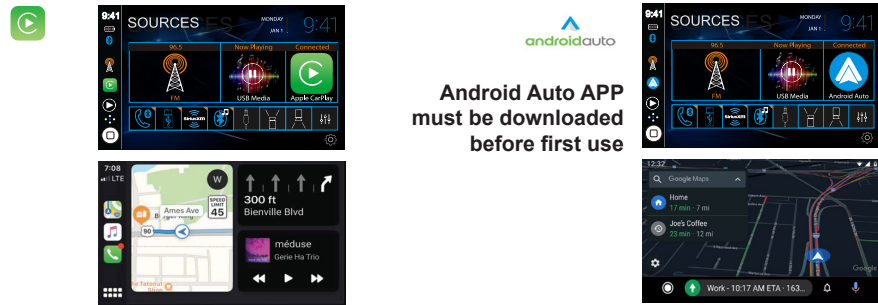

Tuner Operation

Select the Tuner icon

1. Quick Select Sources
2. AM/FM/SXM BAND Selector
3. BAND 1 2 3 Presets 1~18
4. Stereo | Mono
5. Local | Distance
6. Station RBDS Information
7. Quick Select BAND 1 2 3
8. EQ Info
9. Additional Options
10. Direct Equalizer
11. Next
12. Direct Channel Entry
13. Station
14. Direct Station Entry
15. Preset Scan
16. Previous
17. Local | Distance



Media Player Operation

USB Media Player operation

1. Quick Select Sources
2. Current Source
3. Now Playing - Album Art / ID3
4. Direct to Files
5. File Number
6. Track Time / Status Bar
7. EQ Settings
8. Track Up
9. Shuffle On / Off
10. Play/Pause
11. FF/FR Scrub Bar
12. Track Down
13. Repeat Track | Folder | All

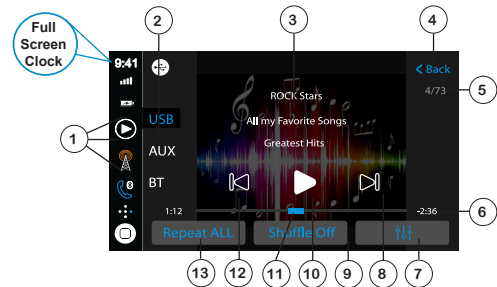

Handfree Operation

Bluetooth Microphone - The external microphone connected to the rear of the receiver.
• To ensure the best conversation quality/performance, stay within 3 feet (1 meter) of the unit's microphone when talking.

Pairing and Connecting

Before using Bluetooth functions, you must pair your mobile phone to the **CAR689**. The device name is "**JENSEN CAR689**". The Bluetooth passcode is random. To ensure the best reception for pairing and re-connection, please make sure the mobile phone battery is fully charged before you begin.

- Try to perform pairing within a few minutes of the mobile phone being turned on.
- Once the unit has been paired with the mobile phone, the unit's model number, "**JENSEN CAR689**", will be displayed on the mobile phone.
- To achieve the best performance, always keep the mobile phone within 10 feet (3 meters) of the unit.
- Always keep a clear path between the mobile phone and the unit. Never place a metal object or any other obstacle between the mobile phone and the unit.
- Some mobile phones may have a "Power Saving Mode" option. PLEASE DO NOT use the power saving mode with the **CAR689**.
- Before accepting or making a call, make sure your mobile phone's "Bluetooth function" is turned on.



Dialing a Number
Press keypad to dial a number.



Making a Call
Dial number, press to connect a call

1. Top Used Sources
2. Signal Strength
3. Keypad
4. Contacts
5. Recent Calls
6. Device
7. Phone Number
8. Backspace
9. Dial Out
10. Keypad

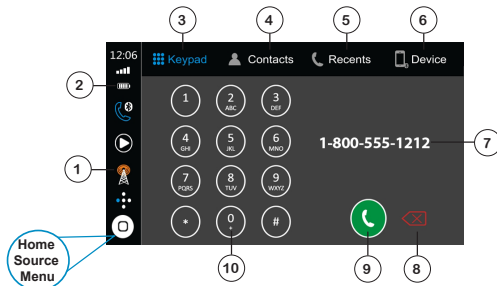

Transferring Audio
Press to transfer call audio between the headunit and mobile phone

1. Hang Up
2. MIC Mute
3. Return to Keypad
4. Call Transfer

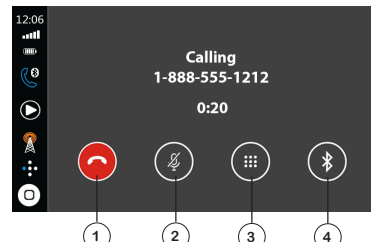

EQ Operation

Press EQ icon in each Source to select EQ settings

Source Tone Memory - Each Source will remember their EQ settings

1. 10-Band Sliders
2. 6 Presets + 1 Custom
3. RESET
4. Exit EQ

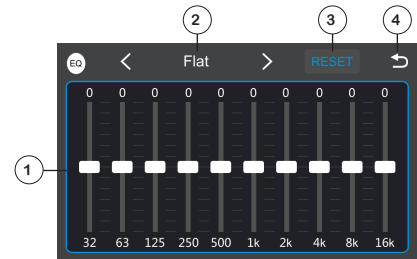

Addition System Audio settings are in System Settings/Audio

Balance: Left | Right
Fader: Front | Rear
SUB: ON/OFF
SUB Crossover Filter: OFF | 50Hz | 80Hz | 120Hz | 160Hz
Equalizer (Affects same settings as from current SOURCE)
Loudness: ON/OFF

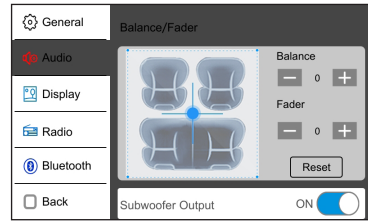

System Settings

Press GEAR icon in MAIN Source Menu

1. General Setup
2. System Audio
3. Display - RGB LED, TFT
4. Radio Settings
5. Bluetooth
6. Camera
7. About - Software Version

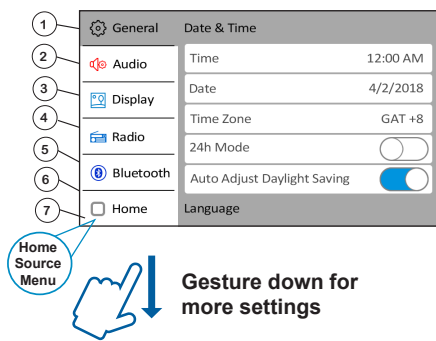

One-Year Limited Warranty

This warranty gives you specific legal rights. You may also have other rights which vary from state to state. Namsung America Inc. warrants this product to the original purchaser to be free from defects in material and workmanship for a period of one year from the date of the original purchase.

Namsung America Inc. agrees, at our option, during the warranty period, to repair any defect in material or workmanship or to furnish an equal new, renewed or comparable product (whichever is deemed necessary) in exchange without charges, subject to verification of the defect or malfunction and proof of the date of purchase. Subsequent replacement products are warranted for the balance of the original warranty period.

Who is covered?
This warranty is extended to the original retail purchaser for products purchased from an authorized Jensen dealer and used in the U.S.A.

What is covered?
This warranty covers all defects in material and workmanship in this product. The following are not covered: software, installation/removal costs, damage resulting from accident, misuse, abuse, neglect, product modification, improper installation, incorrect line voltage, unauthorized repair or failure to follow instructions supplied with the product, or damage occurring during return shipment of the product. Specific license conditions and copyright notices for the software can be found via www.jensenmobile.com.

What to do?

1. Before you call for service, check the troubleshooting guide in your owner's manual. A slight adjustment of any custom controls may save you a service call.
2. If you require service during the warranty period, you must carefully pack the product (preferably in the original package) and ship it by prepaid transportation with a copy of the original receipt from the retailer to an authorized service center.
3. Please describe your problem in writing and include your name, a return UPS shipping address (P.O. Box not acceptable), and a daytime phone number with your shipment.
4. For more information and for the location of the nearest authorized service center please contact us by one of the following methods:

• Call us toll-free at 1-888-921-4088 (Monday-Friday, 9:00 a.m. to 5:00 p.m. EST)

• E-mail us at cs@jensenmobile.com

Exclusion of Certain Damages: This warranty is exclusive and in lieu of any and all other warranties, expressed or implied, including without limitation the implied warranties of merchantability and fitness for a particular purpose and any obligation, liability, right, claim or remedy in contract or tort, whether or not arising from the company's negligence, actual or imputed. No person or representative is authorized to assume for the company any other liability in connection with the sale of this product. In no event shall the company be liable for indirect, incidental or consequential damages.

FCC Compliance

This device complies with Part 15 of the FCC Rules. Operation is subject to the following two conditions:
(1) This device may not cause harmful interference, and
(2) This device must accept any interference received, including interference that may cause undesired operation.
Warning: Changes or modifications to this unit not expressly approved by the party responsible for compliance could void the user's authority to operate the equipment.
Note: This equipment has been tested and found to comply with the limits for a Class B digital device, pursuant to Part 15 of the FCC Rules. These limits are designed to provide reasonable protection against harmful interference in a residential installation. This equipment generates, uses and can radiate radio frequency energy and, if not installed and used in accordance with the instructions, may cause harmful interference to radio communications. However, there is no guarantee that interference will not occur in a particular installation. If this equipment does cause harmful interference to radio or television reception, which can be determined by turning the equipment off and on, the user is encouraged to try to correct the interference by one or more of the following measures:

- Reorient or relocate the receiving antenna.
 - Increase the separation between the equipment and receiver.
 - Connect the equipment into an outlet on a circuit different from that to which the receiver is connected.
 - Consult the dealer or an experienced radio/TV technician for help.
- Exclusion of Certain Damages: This warranty is exclusive and in lieu of any and all other warranties, expressed or implied, including without limitation the implied warranties of merchantability and fitness for a particular purpose and any obligation, liability, right, claim or remedy in contract or tort, whether or not arising from the company's negligence, actual or imputed. No person or representative is authorized to assume for the company any other liability in connection with the sale of this product. In no event shall the company be liable for indirect, incidental or consequential damages.

www.jensenmobile.com
©2020 Namsung America Inc.
NSA1219-v01
Printed in China